

# Lincluden After School Group Asset Transfer Request

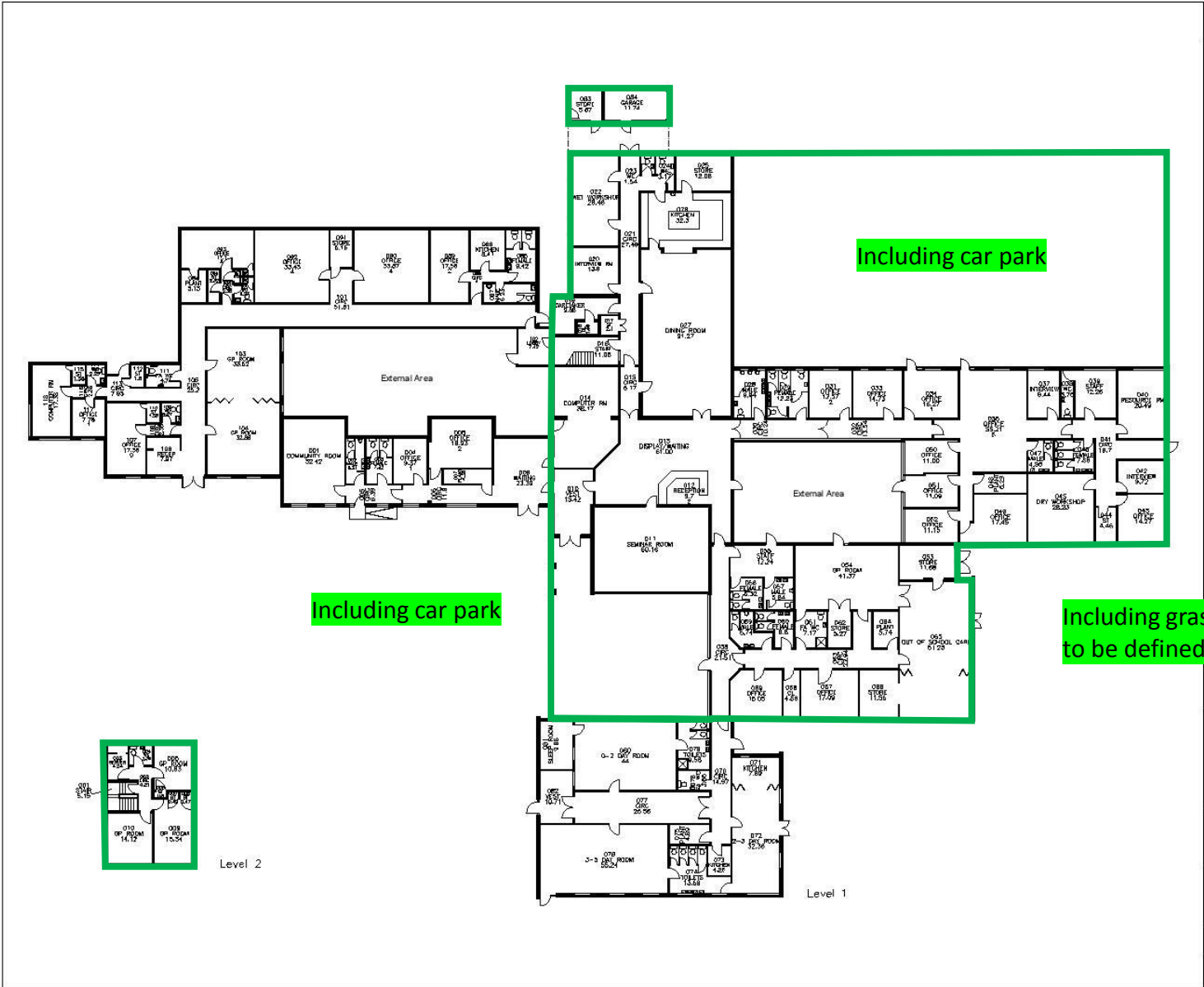

Do not scale from this drawing. All dimensions must be checked & verified on site. The originator should be notified immediately of any discrepancies. This drawing is copyright & remains the property of Dumfries & Galloway Council

Including grassed area to be defined

Including grassed area to be defined

Property & Architectural Services  
 Dumfries and Galloway Council,  
 Gargen Tower,  
 Garroch Business Park,  
 Garroch Loaning,  
 Dumfries, DG2 8PN  
 Tel: 01387 271100 Fax: 01387 271168



Property Details:  
**NORTHWEST RESOURCE CENTRE**  
 COLLEGE ROAD, LINCLUDEN

Drawing Title:  
**APPORTIONMENT**  
**LEVELS 1 & 2**

Scale @ A2: <b>1:200</b>	Drawing Reference: <b>807X00AA</b>
Last Update By: <b>EB</b>	Last Update: <b>28.11.2017</b>