

# MOFFAT ACADEMY P7/S1 TRANSITION

## Information Booklet



# 2024



## Index

- Key Staff in Secondary
- What will my timetable look like?
- School Timings
- Houses
- School Maps - Upstairs
- School Map - Downstairs
- Uniform
- Support
- Key Places

# Key Staff in Secondary



Mrs Woods  
Head Teacher

More staff information  
can be found on our  
school website in  
'Staff Profiles'.



Mrs Candlish  
Depute Head  
Teacher  
Pupil Support



Mr Colquhoun  
Depute Head  
Teacher  
Curriculum and  
Assessment



Mrs Orr  
Principal  
Teacher of  
Learning  
Support



Mrs Ayling  
Pupil Support  
S1

## Timetable Report

Stage: S1

Register Group: REG

Name:

	Reg	1	2	3	4	5	6
<b>Monday</b>	Registration School Mr McPhee Room 11	Science CIE Dr Mair Lab 2	ICT CIE Mr Yuill ICT 1	Physical Education CIE Mr Scott Gms Hall	Science CIE Miss Kadel Lab 4	English CIE Dr Mair Library	Social Subjects CIE Ms Allen Room 3
<b>Tuesday</b>	Registration School Mr McPhee Room 11	Art CIE Miss Mc Guchan Art Room	Technological Studies CIE Mr Spellacy Graphics	Technological Studies CIE Mr Drummond PCS Room	Mathematics CIE Mrs Johnston Room 1	French CIE Miss Denholm Room 9	Drama CIE Miss Cumberland Drama Rm
<b>Wednesday</b>	Registration School Mr McPhee Room 11	Science CIE Miss Kadel Lab 4	Music CIE Mrs Crossan Music Rm	English CIE Mr McPhee Room 11	Physical Education CIE Mr Scott Gms Hall	Drama CIE Miss Cumberland Drama Rm	English CIE Mr McPhee Room 11
<b>Thursday</b>	Registration School Mr McPhee Room 11	Art CIE Miss Mc Guchan Art Room	English CIE Mr McPhee Room 11	Mathematics CIE Mrs Johnston Room 1	Mathematics CIE Mrs Johnston Room 1	French CIE Miss Denholm Room 9	Employability School Mr Yuill ICT 1
	<b>1</b>	<b>2</b>	<b>3</b>	<b>4</b>	<b>5</b>	<b>6</b>	<b>7</b>
<b>Friday</b>	Home Economics CIE Mrs Kirk HE Kirk	Social Subjects CIE Dr Mair Room 8	Social Subjects CIE Mr Pirie Room 7	English CIE Mr McPhee Room 11	Mathematics CIE Mrs Johnston Room 1	Mathematics CIE Mrs Drife Room 2	Religious Studies CIE Dr Mair Room 8

# Secondary School Timings

---

Monday-Thursday		Friday	
Reg (PSE)	0900 - 0925	Period 1	0900 - 0945
Period 1	0925 - 1015	Period 2	0945 - 1030
Period 2	1015 - 1105	Period 3	1030 - 1115
<b>Interval</b>	<b>1105 - 1120</b>	<b>Interval</b>	<b>1115 - 1130</b>
Period 3	1120 - 1210	Period 4	1130 - 1215
Period 4	1210 - 1300	Period 5	1215 - 1305
<b>Lunch</b>	<b>1300 - 1340</b>	<b>Lunch</b>	<b>1305 - 1345</b>
Period 5	1340 - 1430	Period 6	1345 - 1435
Period 6	1430 - 1520	Period 7	1435 - 1525

# Secondary Sports Houses

---



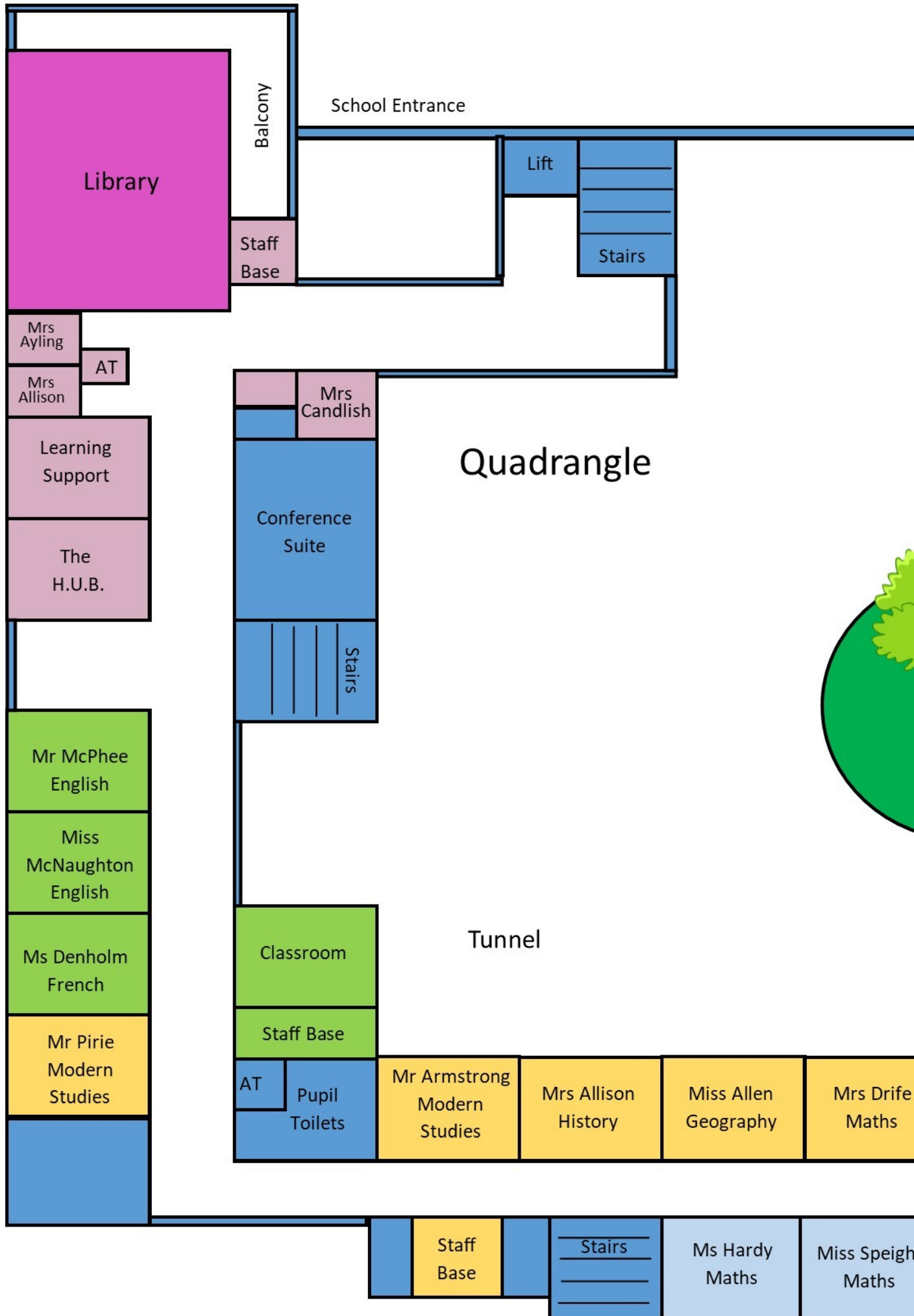

# Upper Level

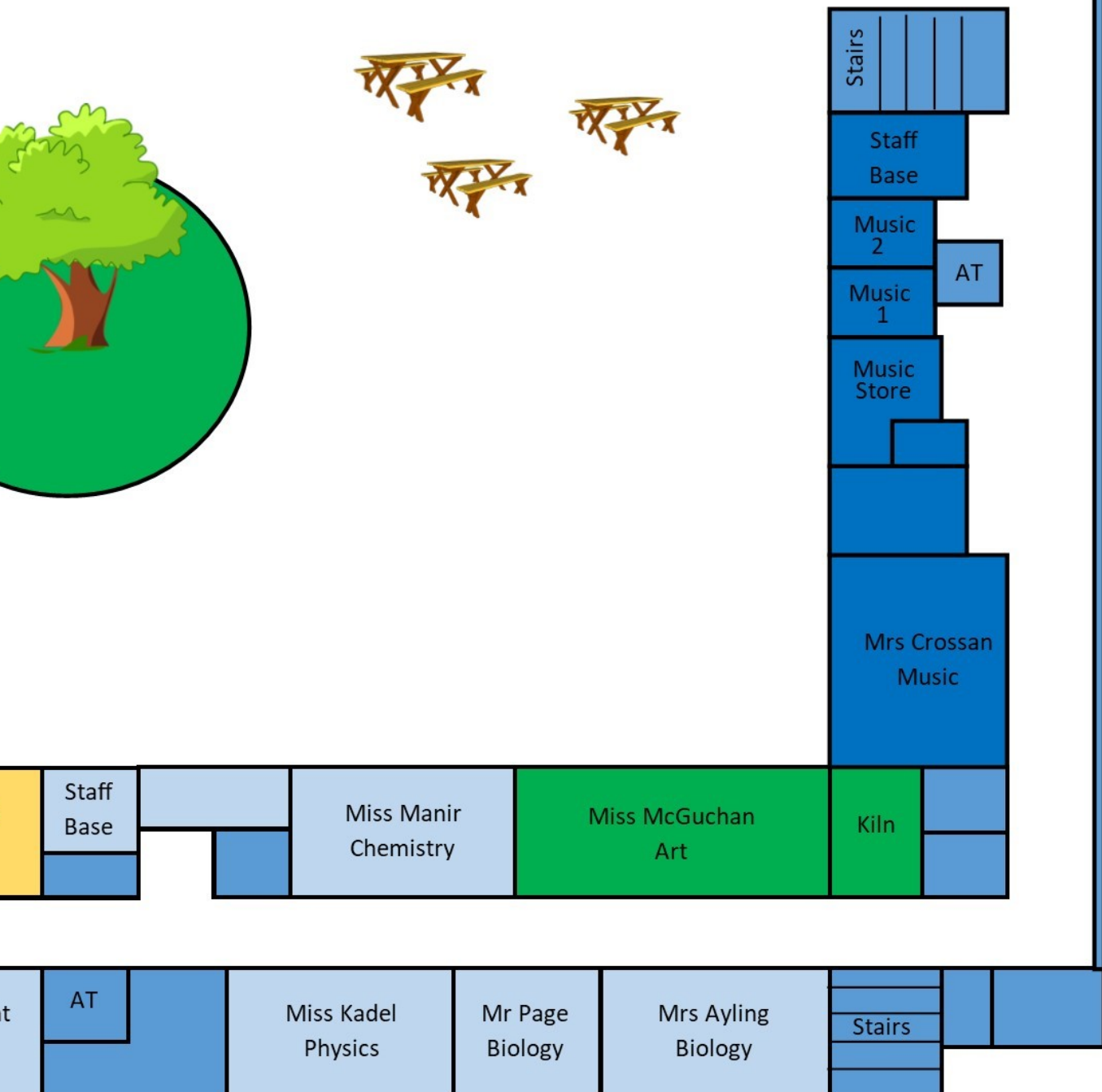

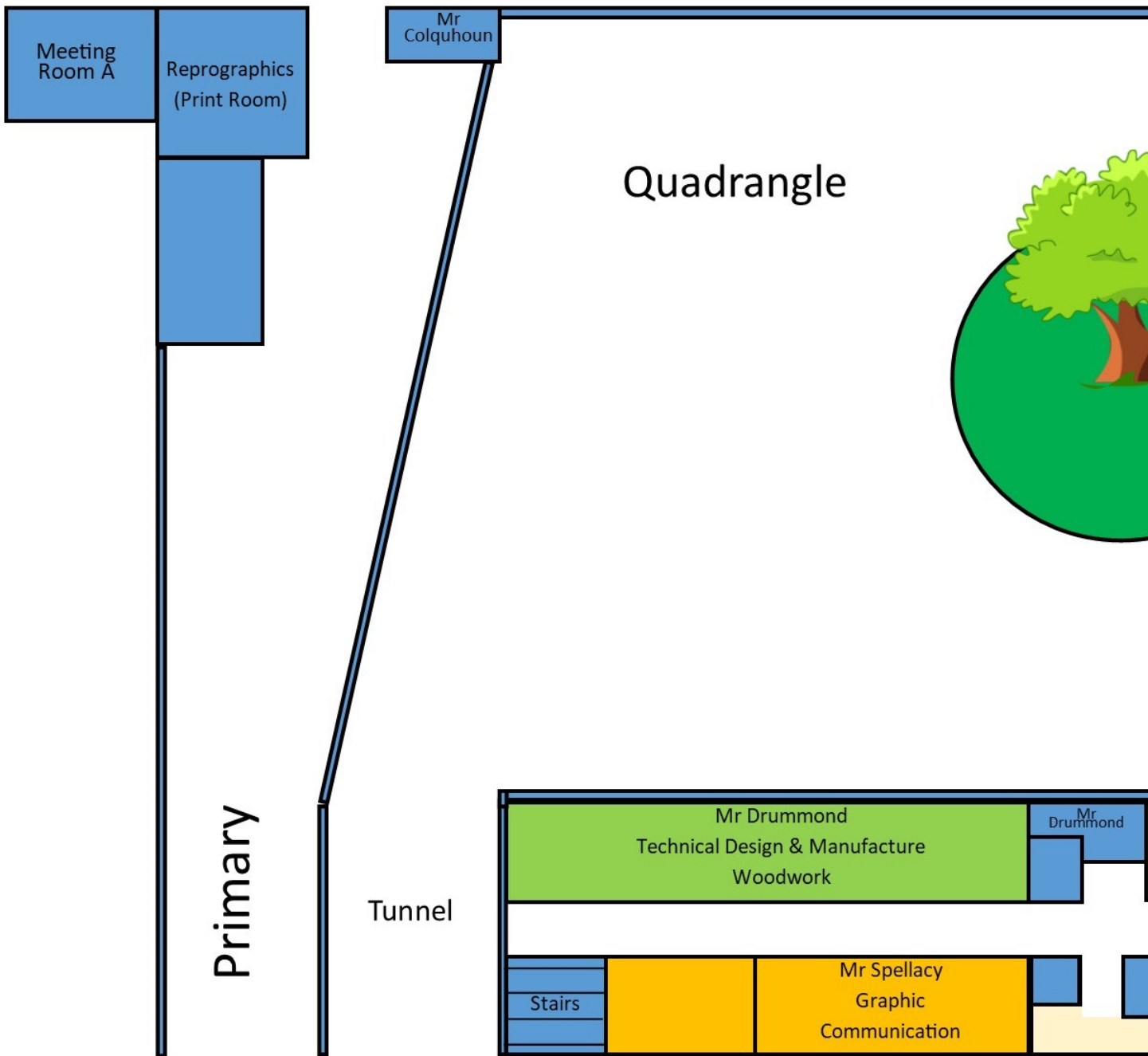
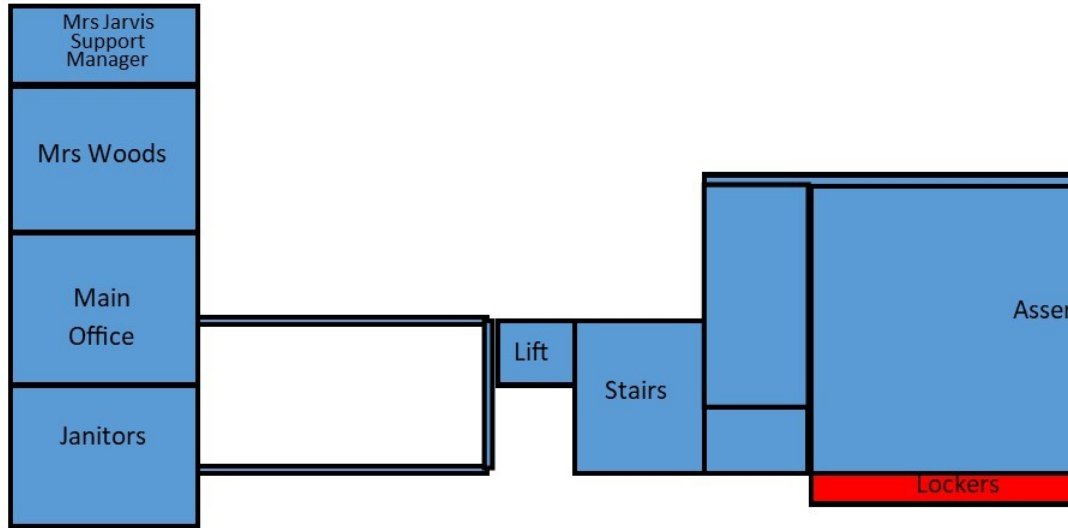



# Lower Level



# School Dress

---

**All students in all year groups (S1-S6) are asked to wear:**

- White shirt (with collar and buttons to the neck)
- Moffat Academy school tie
- All items in black: jumper, sweatshirt, fleece, cardigan or hoodie –school logo available as an option if preferred
- All items in black: trousers / dress shorts / jeggings / skort / pinafore / skirt / treggings
- Traditional Woollen Kilt – plain black / family tartan
- Mainly black, comfortable shoes
- Any additional item of headwear for religious reasons to also be plain black or Moffat Academy school colours.

**We are about being smart and really flexible, to express yourself and to be comfortable at school.**



## Working together to keep Moffat Academy...

- **Inclusive**
- **Achieving**
- **Healthy and safe**
- **Smart and respectful**



**PE Uniform:** The following items should be brought for every PE lesson and extra curricular sporting opportunities:-

- Trainers
- Black or navy shorts, joggers or lycra sport leggings
- Plain black or white T-shirt or polo shirt
- Warm top or hoodie for outdoor activities in colder weather

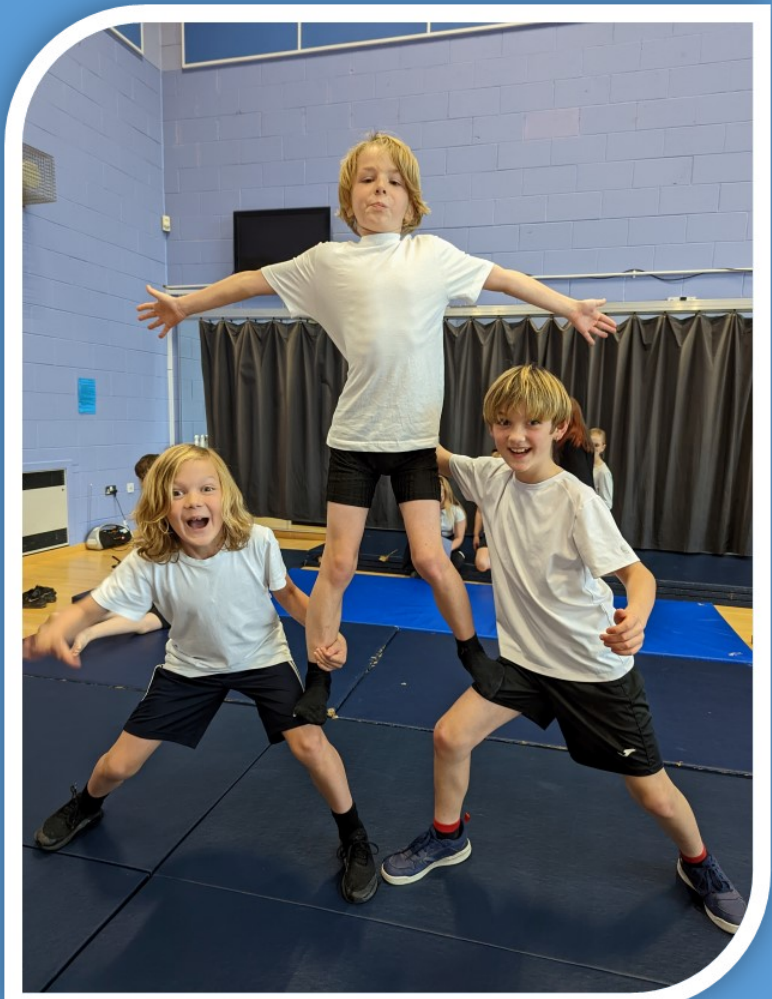

# Support



## MVPs

MVP (Mentors in Violence Prevention) is a national approach to gender violence and bullying prevention. The project is designed to train students to speak out against bullying and all forms of violent and abusive

behaviour. MVP focuses on an innovative 'bystander' approach that empowers each student to take an active role in promoting a positive school climate.

## Buddies

Groups of the new S1 pupils are teamed up with the S6s and meet on a regular basis throughout the school year. The S6s act as mentors and are there for the S1s to ask for advice. Topics discussed include- Settling into S1, Homework advice, Positive friendships, Revision tips, Drug misuse and Internet safety.

## Pupil Support Staff

Mrs Ayling is PT Pupil Support for S1. This is a point of contact that you can go to with any questions worries or issues in any area of your life.

Mrs Ayling: [gw08aylingmelanie@ea.dumgal.sch.uk](mailto:gw08aylingmelanie@ea.dumgal.sch.uk)

In the absence of Mrs Ayling, Mrs Candlish is also available to speak to. Should you have any concerns and worries about your safety, Mrs Candlish is the Child Protection and Safeguarding contact for Moffat Academy.

Mrs Candlish: [gw08candlishkirstin@ea.dumgal.sch.uk](mailto:gw08candlishkirstin@ea.dumgal.sch.uk)



## Office Staff and Library



Mrs Green

If you are needing any information regarding timetables, directions, feeling unwell or if you are looking for a member of Pupil Support etc, please don't hesitate to ask any of the Office Staff or Miss Gibbon in the Library.



Mrs Smith



Mrs Smith



Miss Gibbon

## Any Trusted Adult

Trusted adults are people whose words and actions make you feel safe. Trusted adults act this way both online and offline.

Some examples of a trusted adult are; a teacher, a mentor, a parent, a coach— anyone who loves you and respects you. It is always OK to ask for help from any trusted adult and to keep asking the same person or another trusted adult if they don't understand or if you don't get the help that you need.

# Break and Lunchtimes

---

Pupils can access the canteen at break and lunch for hot or cold meals and snacks. In addition, pupils in Secondary may also go down the street for lunch. There are a variety of areas you can sit such as the picnic benches, MUGA area, canteen or social corridor.



# Break and Lunchtimes

